

# 3000 Series

Pneumatic application



Danfoss Hansen 3000/4000/5000/6000 Series Industrial Interchange pin lock pneumatic quick disconnect couplings are designed for compressed air, gases, and liquids. This series sets the industry standard for pin lock style pneumatic couplings.

### Product Features

- Easy, automatic, push-to-connect design provides instantaneous connection and disconnection of lines, plus automatic shut-off of socket/female end of line
- All sizes accept US industrial Interchange; 1/4" & 1/2" also accept ISO 6150 Series B and A-A-59439 plugs/males
- Optional sleeve lock option prevents accidental disconnection
- Standard body material: Brass
- Standard seal material: Buna-N
- Optional seal and valve materials: Silicone-138, FKM-143, EPDM-192

### Physical Characteristics

| Series | Body Size | Max. Operating Pressure |       | Min. Burst Pressure |       | Rated Flow |      |
|--------|-----------|-------------------------|-------|---------------------|-------|------------|------|
|        | (in)      | (bar)                   | (psi) | (bar)               | (psi) | (lpm)      | scfm |
| 3000   | 1/4       | 138                     | 2,000 | 552                 | 8,000 | 680        | 24   |
| 4000   | 3/8       | 69                      | 1,000 | 276                 | 4,000 | 1,274      | 45   |
| 5000   | 1/2       | 35                      | 500   | 140                 | 2,000 | 2,040      | 72   |
| 6000   | 3/4       | 15                      | 220   | 60                  | 880   | 3,540      | 125  |

### Applications & Markets

- Industrial Breathing Air
- General Pneumatics
- Maintenance & Repair
- Fluid Transfer

### Interchangeability

| All Sizes                 | 1/4" & 1/2"   |
|---------------------------|---|
| US Industrial Interchange | ISO 6150 Series B<br>A-A-59439<br>(former MIL-C-4109) |

### Flow Data

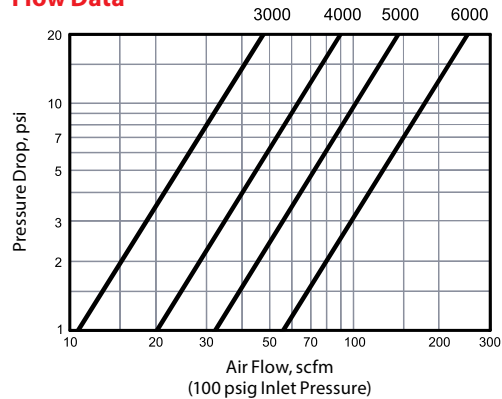

# 3000 Series

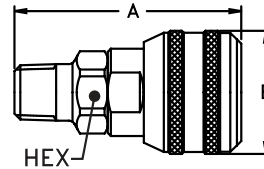

Figure 1

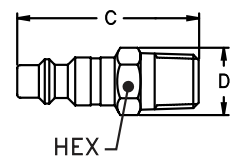

Figure 2

## Male End Connections

| Part Number | Coupling Type | Body Size | Port Size | Thread  | Type | Material | Fig. | Dimensions |      |      | Hex   | A     | B     | Hex |
|-------------|---------------|-----------|-----------|---------|------|----------|------|------------|------|------|-------|-------|-------|-----|
|             |               |           |           |         |      |          |      | A          | B    | Hex  |       |       |       |     |
|             |               |           |           |         |      |          |      | (in)       | (in) | (in) |       |       |       |     |
| 2900        | Socket/Female | 1/4       | 1/8       | 1/8-27  | NPTF | Brass    | 1    | 2.00       | 1.19 | 0.69 | 50.80 | 30.23 | 17.53 |     |
| 3100E       | Socket/Female | 1/4       | 1/4       | 1/4-18  | NPTF | Brass    | 1    | 2.19       | 1.19 | 0.69 | 55.63 | 30.23 | 17.53 |     |
| 3300E       | Socket/Female | 1/4       | 3/8       | 3/8-18  | NPTF | Brass    | 1    | 2.15       | 1.19 | 0.69 | 54.61 | 30.23 | 17.53 |     |
| 300043*     | Socket/Female | 1/4       | 7/16      | 7/16-20 | UNF  | Brass    | 1    | 2.10       | 1.19 | 0.69 | 53.34 | 30.23 | 17.53 |     |

| Part Number | Coupling Type | Body Size | Port Size | Thread | Type | Material  | Fig. | Dimensions |      |      | Hex   | C     | D     | Hex |
|-------------|---------------|-----------|-----------|--------|------|-----------|------|------------|------|------|-------|-------|-------|-----|
|             |               |           |           |        |      |           |      | C          | D    | Hex  |       |       |       |     |
|             |               |           |           |        |      |           |      | (in)       | (in) | (in) |       |       |       |     |
| 10          | Plug/Male     | 1/4       | 1/4       | 1/4-18 | NPTF | Steel     | 2    | 1.75       | 0.62 | 0.56 | 44.45 | 15.85 | 14.22 |     |
| 10CS        | Plug/Male     | 1/4       | 1/4       | 1/4-18 | NPTF | Steel     | 2    | 1.75       | 0.65 | 0.56 | 44.45 | 16.51 | 14.22 |     |
| 10G†        | Plug/Male     | 1/4       | 1/4       | 1/4-18 | NPTF | Steel     | 2    | 1.75       | 0.65 | 0.56 | 44.45 | 16.51 | 14.22 |     |
| 12E         | Plug/Male     | 1/4       | 1/8       | 1/8-27 | NPTF | Steel     | 2    | 1.59       | 0.58 | 0.50 | 40.39 | 14.73 | 12.70 |     |
| 12G†        | Plug/Male     | 1/4       | 1/8       | 1/8-27 | NPTF | Steel     | 2    | 2.38       | 0.77 | 0.69 | 60.45 | 19.56 | 17.53 |     |
| 14          | Plug/Male     | 1/4       | 3/8       | 3/8-18 | NPTF | Steel     | 2    | 1.75       | 0.79 | 0.69 | 44.45 | 20.07 | 17.53 |     |
| 14G†        | Plug/Male     | 1/4       | 3/8       | 3/8-18 | NPTF | Steel     | 2    | 2.53       | 0.77 | 0.69 | 64.26 | 19.56 | 17.53 |     |
| B10         | Plug/Male     | 1/4       | 1/4       | 1/4-18 | NPTF | Brass     | 2    | 1.75       | 0.62 | 0.56 | 44.45 | 15.75 | 14.22 |     |
| LL10        | Plug/Male     | 1/4       | 1/4       | 1/4-18 | NPTF | Stainless | 2    | 1.75       | 0.62 | 0.56 | 44.45 | 15.85 | 14.22 |     |
| 10NK**      | Plug/Male     | 1/4       | 1/4       | 1/4-18 | NPTF | Steel     | 2    | 1.75       | 0.62 | 0.56 | 44.45 | 15.75 | 14.22 |     |

\*45° Male Flare †With Ball Check ‡With Bleeder Ball Check—Reduces Hose Whip \*\*Nickel plated

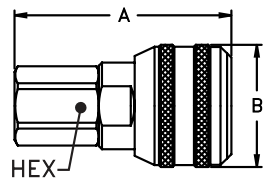

Figure 3

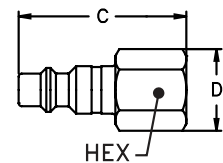

Figure 4

## Female End Connections

| Part Number | Coupling Type | Body Size | Port Size | Thread | Type | Material | Fig. | Dimensions |      |      | Hex   | A     | B     | Hex |
|-------------|---------------|-----------|-----------|--------|------|----------|------|------------|------|------|-------|-------|-------|-----|
|             |               |           |           |        |      |          |      | A          | B    | Hex  |       |       |       |     |
|             |               |           |           |        |      |          |      | (in)       | (in) | (in) |       |       |       |     |
| 2800        | Socket/Female | 1/4       | 1/8       | 1/8-27 | NPTF | Brass    | 3    | 1.89       | 1.19 | 0.69 | 48.01 | 30.23 | 17.53 |     |
| 3000        | Socket/Female | 1/4       | 1/4       | 1/4-18 | NPTF | Brass    | 3    | 2.11       | 1.19 | 0.69 | 53.59 | 30.23 | 17.53 |     |
| 3200        | Socket/Female | 1/4       | 3/8       | 3/8-18 | NPTF | Brass    | 3    | 2.19       | 1.19 | 0.75 | 55.63 | 30.23 | 19.05 |     |

| Part Number | Coupling Type | Body Size | Port Size | Thread | Type | Material  | Fig. | Dimensions |      |      | Hex   | C     | D     | Hex |
|-------------|---------------|-----------|-----------|--------|------|-----------|------|------------|------|------|-------|-------|-------|-----|
|             |               |           |           |        |      |           |      | C          | D    | Hex  |       |       |       |     |
|             |               |           |           |        |      |           |      | (in)       | (in) | (in) |       |       |       |     |
| 11          | Plug/Male     | 1/4       | 1/4       | 1/4-18 | NPTF | Steel     | 4    | 1.63       | 0.79 | 0.69 | 41.40 | 20.07 | 17.53 |     |
| 11G†        | Plug/Male     | 1/4       | 1/4       | 1/4-18 | NPTF | Steel     | 4    | 2.44       | 0.77 | 0.69 | 61.98 | 19.56 | 17.53 |     |
| 13          | Plug/Male     | 1/4       | 1/8       | 1/8-27 | NPTF | Steel     | 4    | 1.47       | 0.65 | 0.56 | 37.34 | 16.51 | 14.22 |     |
| 15E         | Plug/Male     | 1/4       | 3/8       | 3/8-18 | NPTF | Steel     | 4    | 1.69       | 0.94 | 0.81 | 42.93 | 23.88 | 20.57 |     |
| 11B         | Plug/Male     | 1/4       | 1/4       | 1/4-18 | NPTF | Brass     | 4    | 1.63       | 0.79 | 0.69 | 41.40 | 20.07 | 17.53 |     |
| LL11        | Plug/Male     | 1/4       | 1/4       | 1/4-18 | NPTF | Stainless | 4    | 1.63       | 0.79 | 0.69 | 41.40 | 20.07 | 17.53 |     |
| 11NK*       | Plug/Male     | 1/4       | 1/4       | 1/4-18 | NPTF | Steel     | 4    | 1.63       | 0.79 | 0.69 | 41.40 | 20.07 | 17.53 |     |

†With Bleeder Ball Check—Reduces Hose Whip \*Nickel plated

# 3000 Series

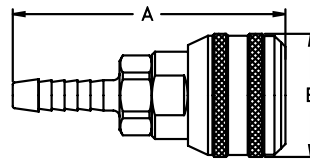

Figure 5

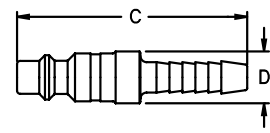
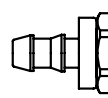

Figure 6

## Hose Stem End Connections

| Part Number | Coupling Type | Body Size | Hose I.D. | Material | Fig. | Dimensions |      | A     | B     |
|-------------|---------------|-----------|-----------|----------|------|------------|------|-------|-------|
|             |               |           |           |          |      | A          | B    |       |       |
|             |               |           |           |          |      | (in)       | (in) | (mm)  | (mm)  |
| 3600        | Socket/Female | 1/4       | 1/4       | Brass    | 5    | 2.63       | 1.19 | 66.80 | 30.23 |
| 3600P‡      | Socket/Female | 1/4       | 1/4       | Brass    | 5,5A | 2.40       | 1.19 | 60.96 | 30.23 |
| 3700E       | Socket/Female | 1/4       | 3/8       | Brass    | 5    | 2.63       | 1.19 | 66.80 | 30.23 |
| 3700P‡      | Socket/Female | 1/4       | 3/8       | Brass    | 5,5A | 2.47       | 1.19 | 62.74 | 30.23 |
| 3800        | Socket/Female | 1/4       | 5/16      | Brass    | 5    | 2.63       | 1.19 | 66.80 | 30.23 |
| Part Number | Coupling Type | Body Size | Hose I.D. | Material | Fig. | Dimensions |      | C     | D     |
|             |               |           |           |          |      | C          | D    |       |       |
|             |               |           |           |          |      | (in)       | (in) | (mm)  | (mm)  |
| 16          | Plug/Male     | 1/4       | 1/4       | Steel    | 6    | 2.22       | 0.50 | 56.39 | 12.70 |
| 16G†        | Plug/Male     | 1/4       | 1/4       | Steel    | 6    | 2.97       | 0.77 | 75.44 | 19.56 |
| 16P‡        | Plug/Male     | 1/4       | 1/4       | Steel    | 6,6A | 2.00       | 0.58 | 50.80 | 14.73 |
| 17          | Plug/Male     | 1/4       | 3/8       | Steel    | 6    | 2.22       | 0.50 | 56.39 | 12.70 |
| 17G†        | Plug/Male     | 1/4       | 3/8       | Steel    | 6    | 2.96       | 0.77 | 75.18 | 19.56 |
| 17P‡        | Plug/Male     | 1/4       | 3/8       | Steel    | 6,6A | 2.06       | 0.5  | 52.32 | 12.70 |
| 18E         | Plug/Male     | 1/4       | 5/16      | Steel    | 6    | 2.22       | 0.50 | 56.39 | 12.70 |
| B17         | Plug/Male     | 1/4       | 3/8       | Brass    | 6    | 2.22       | 0.50 | 56.39 | 12.70 |
| 16NK*       | Plug/Male     | 1/4       | 1/4       | Steel    | 6    | 2.22       | 0.5  | 56.39 | 12.70 |
| 17NK*       | Plug/Male     | 1/4       | 3/8       | Steel    | 6    | 2.22       | 0.5  | 56.39 | 12.70 |

†With Bleeder Ball Checkv—Reduces Hose Whip ‡For use with push-on style hose \*Nickel plated



3600P

Figure 5A

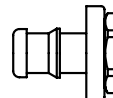

3700P

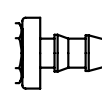

16P

Figure 6A

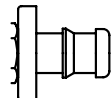

17P

# 3000 Series

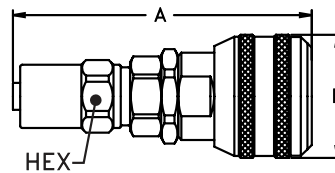

Figure 7

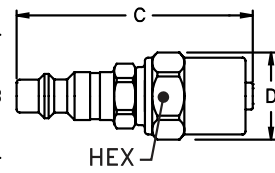

Figure 8

## Hose Clamp End Connections

| Part Number | Coupling Type | Body Size | Hose I.D. | Hose O.D. | Material | Fig. | Dimensions |      |      | A     | B     | Hex   |
|-------------|---------------|-----------|-----------|-----------|----------|------|------------|------|------|-------|-------|-------|
|             |               |           |           |           |          |      | A          | B    | Hex  |       |       |       |
|             |               |           |           |           |          |      | (in)       | (in) | (in) | (mm)  | (mm)  | (mm)  |
| 3SA0        | Socket/Female | 1/4       | 3/16      | 7/16      | Brass    | 7    | 2.65       | 1.19 | 0.56 | 67.31 | 30.23 | 14.22 |
| 3SB1        | Socket/Female | 1/4       | 1/4       | 15/32     | Brass    | 7    | 2.72       | 1.19 | 0.63 | 69.09 | 30.23 | 16.00 |
| 3SB3        | Socket/Female | 1/4       | 1/4       | 1/2       | Brass    | 7    | 2.72       | 1.19 | 0.63 | 69.09 | 30.23 | 16.00 |
| 3SB5        | Socket/Female | 1/4       | 1/4       | 9/16      | Brass    | 7    | 2.72       | 1.19 | 0.69 | 69.09 | 30.23 | 17.53 |
| 3SB7        | Socket/Female | 1/4       | 1/4       | 5/8       | Brass    | 7    | 2.72       | 1.19 | 0.75 | 69.09 | 30.23 | 19.05 |
| 3SB9        | Socket/Female | 1/4       | 1/4       | 11/16     | Brass    | 7    | 2.72       | 1.19 | 0.81 | 69.09 | 30.23 | 20.57 |
| 3SC5        | Socket/Female | 1/4       | 5/16      | 9/16      | Brass    | 7    | 2.78       | 1.19 | 0.69 | 70.61 | 30.23 | 17.53 |
| 3SC7        | Socket/Female | 1/4       | 5/16      | 5/8       | Brass    | 7    | 2.78       | 1.19 | 0.75 | 70.61 | 30.23 | 19.05 |
| 3SC9        | Socket/Female | 1/4       | 5/16      | 11/16     | Brass    | 7    | 2.78       | 1.19 | 0.81 | 70.61 | 30.23 | 20.57 |
| 3SD5        | Socket/Female | 1/4       | 3/8       | 9/16      | Brass    | 7    | 2.84       | 1.19 | 0.69 | 72.14 | 30.23 | 17.53 |
| 3SD7        | Socket/Female | 1/4       | 3/8       | 5/8       | Brass    | 7    | 2.84       | 1.19 | 0.75 | 72.14 | 30.23 | 19.05 |
| 3SD9        | Socket/Female | 1/4       | 3/8       | 11/16     | Brass    | 7    | 2.84       | 1.19 | 0.81 | 72.14 | 30.23 | 20.57 |
| 3SD11       | Socket/Female | 1/4       | 3/8       | 3/4       | Brass    | 7    | 2.84       | 1.19 | 0.88 | 72.14 | 30.23 | 22.35 |
| Part Number | Coupling Type | Body Size | Hose I.D. | Hose O.D. | Material | Fig. | Dimensions |      |      | C     | D     | Hex   |
|             |               |           |           |           |          |      | C          | D    | Hex  |       |       |       |
|             |               |           |           |           |          |      | (in)       | (in) | (in) | (mm)  | (mm)  | (mm)  |
| 3PB1        | Plug/Male     | 1/4       | 1/4       | 15/32     | Steel    | 8    | 2.31       | 0.70 | 0.63 | 58.67 | 17.78 | 16.00 |
| 3PB3        | Plug/Male     | 1/4       | 1/4       | 1/2       | Steel    | 8    | 2.31       | 0.70 | 0.63 | 58.67 | 17.78 | 16.00 |
| 3PB5        | Plug/Male     | 1/4       | 1/4       | 9/16      | Steel    | 8    | 2.31       | 0.77 | 0.69 | 58.67 | 19.56 | 17.53 |
| 3PB7        | Plug/Male     | 1/4       | 1/4       | 5/8       | Steel    | 8    | 2.31       | 0.84 | 0.75 | 58.67 | 21.34 | 19.05 |
| 3PB9        | Plug/Male     | 1/4       | 1/4       | 11/16     | Steel    | 8    | 2.31       | 0.91 | 0.81 | 58.67 | 23.11 | 20.57 |
| 3PB11       | Plug/Male     | 1/4       | 1/4       | 3/4       | Steel    | 8    | 2.31       | 0.98 | 0.88 | 58.67 | 24.89 | 22.35 |
| 3PC5        | Plug/Male     | 1/4       | 5/16      | 9/16      | Steel    | 8    | 2.38       | 0.77 | 0.69 | 60.45 | 19.56 | 17.53 |
| 3PC7        | Plug/Male     | 1/4       | 5/16      | 5/8       | Steel    | 8    | 2.38       | 0.84 | 0.75 | 60.45 | 21.34 | 19.05 |
| 3PC9        | Plug/Male     | 1/4       | 5/16      | 11/16     | Steel    | 8    | 2.38       | 0.91 | 0.81 | 60.45 | 23.11 | 20.57 |
| 3PD5        | Plug/Male     | 1/4       | 3/8       | 9/16      | Steel    | 8    | 2.44       | 0.77 | 0.69 | 61.98 | 19.56 | 17.53 |
| 3PD7        | Plug/Male     | 1/4       | 3/8       | 5/8       | Steel    | 8    | 2.44       | 0.84 | 0.75 | 61.98 | 21.34 | 19.05 |
| 3PD9        | Plug/Male     | 1/4       | 3/8       | 11/16     | Steel    | 8    | 2.44       | 0.91 | 0.81 | 61.98 | 23.11 | 20.57 |
| 3PD11       | Plug/Male     | 1/4       | 3/8       | 3/4       | Steel    | 8    | 2.44       | 0.98 | 0.88 | 61.98 | 24.89 | 22.35 |