

SAFLOK Self-Locking Quick Coupler

"Safety for personnel, the environment and reduced costs due to accidental disconnection"

All the convenient ease and multiple uses of a standard cam and groove coupling with higher design and safety properties of a world patented brand named product.

- Prevents accidental disconnection
- Conforms to DIN 2828 & A-A-59326 (Mil-C-27487) specifications
- Patented safety locking cam arm

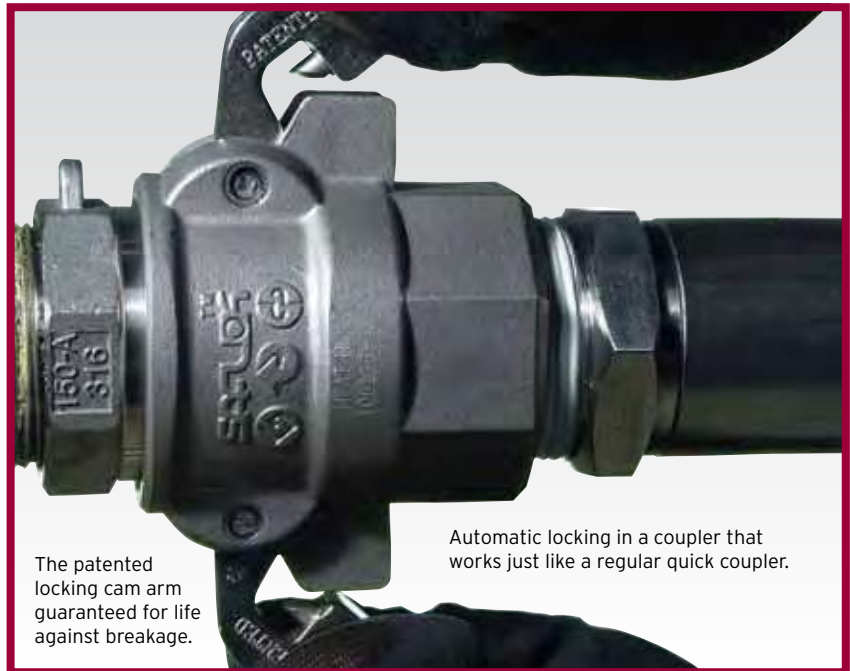

The patented locking cam arm guaranteed for life against breakage.

Automatic locking in a coupler that works just like a regular quick coupler.

Features

- Can be fitted to any standard cam adaptor.
- Material: Stainless Steel with Buna Nitrile seals. Other seals are available on request.
- Sizes: 1/2" to 4", BSP thread.

Available Options

Part B, Part C, Part D and Part DC.

Also available to DIN 2828 specification.

Benefits

Handles automatically lock into the body when closed.

Handles will stay CLOSED until YOU release them.

To open, pull the finger ring down and the handle will open in the normal way.

These couplings will assist in the prevention of spillage of expensive and/or hazardous materials during product transfer processes.

Applications

Specifically for liquid chemicals and pharmaceuticals but also for cosmetics, foodstuffs, inks, adhesives, dyes, particularly where safety and costs are important.

Nominal Size		STAINLESS STEEL			
ins	mm	Part B	Part C	Part D	Part DC
		Coupler with Male Thread BSP	Coupler with Hose Tail	Coupler with Female Thread BSP	Dust Cap
1/2	13	B050-SAFLOK-SS	C050-SAFLOK-SS	D050-SAFLOK-SS	DC050-SAFLOK-SS
3/4	19	B075-SAFLOK-SS	C075-SAFLOK-SS	D075-SAFLOK-SS	DC075-SAFLOK-SS
1	25	B100-SAFLOK-SS	C100-SAFLOK-SS	D100-SAFLOK-SS	DC100-SAFLOK-SS
1 1/4	32	B125-SAFLOK-SS	C125-SAFLOK-SS	D125-SAFLOK-SS	DC125-SAFLOK-SS
1 1/2	40	B150-SAFLOK-SS	C150-SAFLOK-SS	D150-SAFLOK-SS	DC150-SAFLOK-SS
2	50	B200-SAFLOK-SS	C200-SAFLOK-SS	D200-SAFLOK-SS	DC200-SAFLOK-SS
2 1/2	65	B250-SAFLOK-SS	C250-SAFLOK-SS	D250-SAFLOK-SS	DC250-SAFLOK-SS
3	75	B300-SAFLOK-SS	C300-SAFLOK-SS	D300-SAFLOK-SS	DC300-SAFLOK-SS
4	100	B400-SAFLOK-SS	C400-SAFLOK-SS	D400-SAFLOK-SS	DC400-SAFLOK-SS

The standard coupling is supplied with a Buna Nitrile Rubber seal.



GUYSON INTERNATIONAL LIMITED HOSE & COUPLINGS DIVISION

Southview Business Park, Guiseley, Leeds LS20 9PR

Tel: 01943 870044 e-mail: leeds@guyson.co.uk web: www.guyson.co.uk



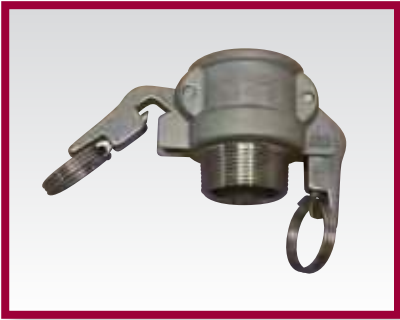

Part B



Part C



Part CRS



Part D



Part DC



Part DU



GUYSON INTERNATIONAL LIMITED **HOSE & COUPLINGS DIVISION**
Southview Business Park, Guiseley, Leeds LS20 9PR
Tel: 01943 870044 e-mail: leeds@guyson.co.uk web: www.guyson.co.uk

